

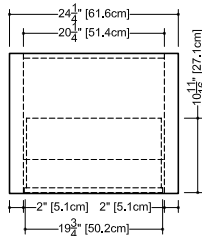

Furniture

Vanity Z 120 – 1 drawer – 20” depth

length - inch 24 - 30 - 36
length - cm 61 - 76 - 91



plan view

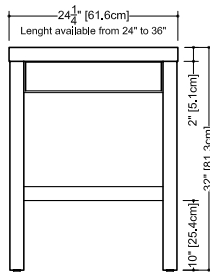

front view

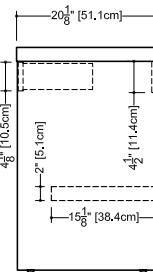

side view

finishes and colors

oak

natural
wenge
white
black
stone harbour grey
coffee bean
smoked

walnut

natural
natural no calico
chocolate

premium wood

torrified eucalyptus
mozambique

- Top part perimeter and all exposed edges of console are made of solid wood 1/8" thick
- Other surfaces are in all natural wood veneer
- AWI rated level 5 marine grade finish for moisture resistance and durability (industry's highest finishing class)
- Solid maple dovetailed drawers
- Adjustable legs
- Recessed handles

**For vessel sink or Cube Metro lavatory combinations
match only with rear drain vessel sink**

WETSTYLE cannot be held responsible for any technical errors and reserves the right to make revisions without notice.

Approximate measurement.
The manufacturer accepts 1/4" (6.35mm) variance.

www.WETSTYLE.COM - Montreal - Canada
Tel. 1 888.536.9001 - service@wetstyle.com





Vanity Z 120 – 2 drawers – 20” depth

length - inch 42 - 48 - 54 - 60 - 66 - 72
length - cm 107 - 122 - 137 - 152 - 167 - 183

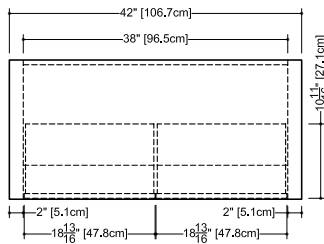

plan view

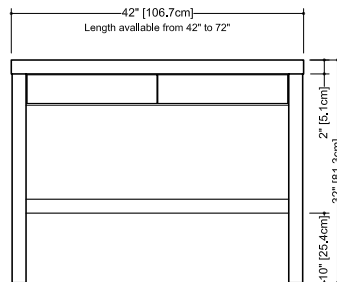

front view

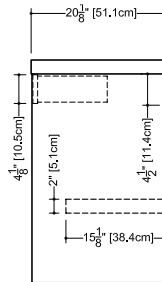

side view

finishes and colors

oak

natural
wenge
white
black
stone harbour grey
coffee bean
smoked

walnut

natural
natural no calico
chocolate

premium wood

torrified eucalyptus
mozambique

- Top part perimeter and all exposed edges of console are made of solid wood 1/8" thick
- Other surfaces are in all natural wood veneer
- AWI rated level 5 marine grade finish for moisture resistance and durability (industry's highest finishing class)
- Solid maple dovetailed drawers
- Adjustable legs
- Recessed handles

**For vessel sink or Cube Metro lavatory combinations
match only with rear drain vessel sink**

WETSTYLE cannot be held responsible for any technical errors and reserves the right to make revisions without notice.

Approximate measurement.
The manufacturer accepts 1/4" (6.35mm) variance.

www.WETSTYLE.COM - Montreal - Canada
Tel. 1 888.536.9001 - service@wetstyle.com

