

Limited Lifetime Faucet Warranty

Fluid™ warrants its faucets to be free from defects in material and workmanship for as long as the original consumer/purchaser/owner owns his or her home.* Plastic and rubber components are warranted for a period of two years. This warranty applies only to original installation locations. If a defect is found in normal residential use, Fluid™ will, at its election, repair, provide a replacement part or product, or make the appropriate adjustment.

Fluid™ reserves the right to examine the product in question and its installation prior to replacement. This warranty is limited to replacement of defective parts only. Damage to a product caused by accident, improper installation, misuse or abuse, improper care of finishes, hard water or mineral deposits, potassium or salt based water softener systems or exposure to corrosive materials is not covered by this warranty. Improper care and cleaning will void the warranty.** Replacement parts can be obtained from your local dealer or directly from the Fluid™ warehouse, (shipping charges may apply). Dated proof of purchase must accompany all warranty claims. This warranty applies only to Fluid™ faucets installed in the United States of America, Canada or Mexico (North America).

Fluid™ recommends using a certified plumber for faucet installation and repair. Incidental and consequential damages, labor charges, repair or replacement costs are expressly excluded. In no event shall the liability of Fluid™ exceed the purchase price of the faucet. Some states and provinces do not allow the exclusion or limitation of incidental or consequential damages, so the above limitation may not apply to you. This warranty gives you specific legal rights which vary from state/province to state/province. If you find any such problem with your product, please immediately contact your nearest Fluid™ dealer or sales representative.

fluid | Sustainable Solutions

Need Help?

For additional assistance
Toll Free: 1 800 460 7019
Fax: 1 604 430 5050
help@sustainablesolutions.com
www.sustainablesolutions.com

Installation Instructions for Switch Retrofit Shower System

* Two year warranty on commercial applications.

** Never use cleaners containing abrasive, ammonia, bleach, acids, waxes, alcohol, solvents or other products not recommended for surface finish. This will void the warranty.

This faucet meets or exceeds the following standards:

ASME A112.18.1 / CSA B125.1

This product has been tested and certified by IAPMO.



IAPMO Listed







**Sustainable
Solutions**

Sustainable Solutions
Phone: 1 800 4607019
www.SustainableSolutions.com

Switch Retrofit Shower System / F9908_F9316 / 2020_V1

Please Keep This Manual For Future Reference

Tools Required for Installations

-  3/32"(2.5mm) Allen Wrench (supplied)
-  5/16"(8mm) Allen Wrench (not supplied)
-  Drill with 1/4"(6mm) and 1/2"(12mm) Bit (not supplied but required if using drilling method)
-  Teflon Tape (not supplied)
-  Adjustable Wrench (not supplied)

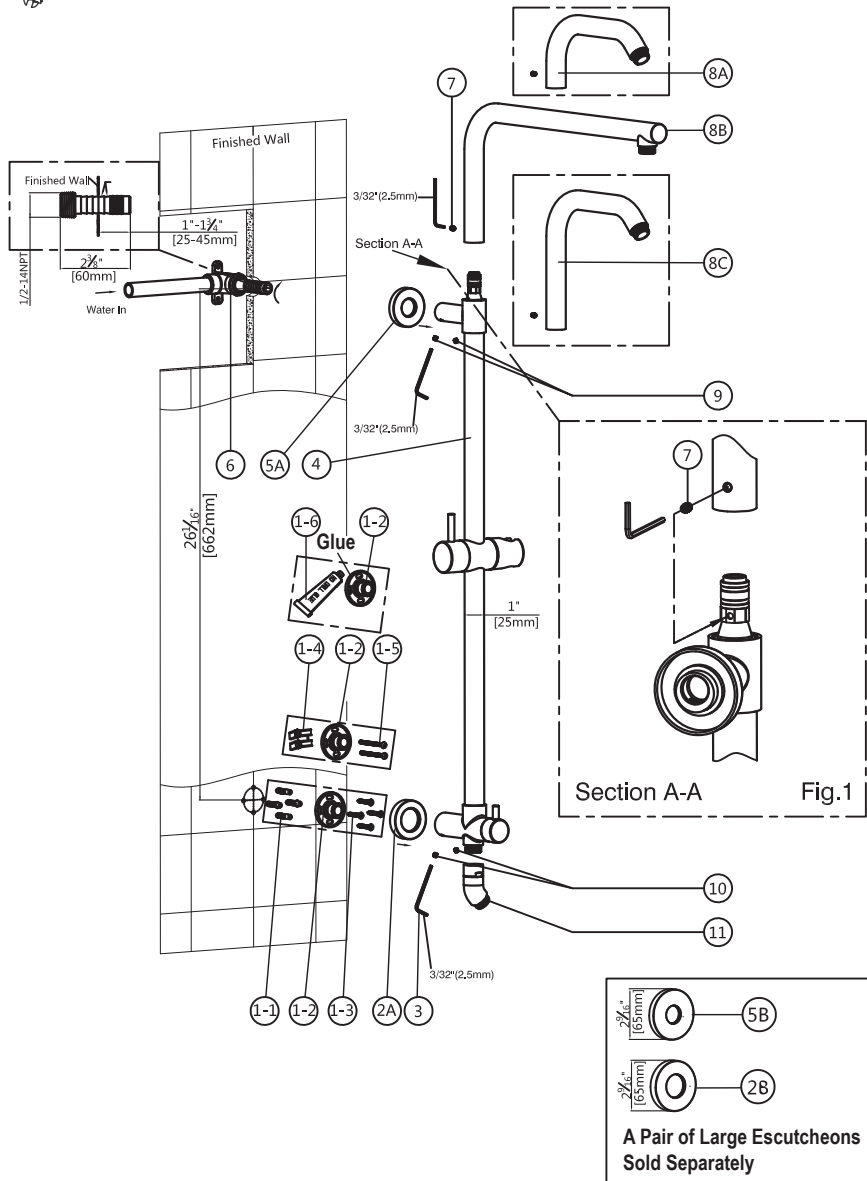

Installation Instructions

1. Shut off water supply.
2. Screw and tighten brass connector (#6) with a 5/16" (8mm) Allen wrench into 1/2" NPT drop elbow (not supplied) behind finished wall after wrapping male threads with Teflon tape. NOTE: if the enclosed brass connector (#6) is short for installation. An extra long 110mm brass connector is available for purchase.
3. Make sure that the length of exposed brass connector (#6) outside the finished wall is between 25 mm (1") and 45 mm (1-3/4"). If the exposed brass connector is shorter than 25 mm (1"), A 1/2" NPT male to female brass fitting can be purchased and added to extend the brass connector (#6).
4. Fit main pipe assembly (#4) on the finished wall by pushing top connection over the brass connector (#6).
5. Determine the proper position of the bottom mounting plate (#1-2) on the finished wall, ensuring that it is level with the top connector. Once the best position is established, use a pencil or non-permanent marker to mark the locations of four holes on the mounting plate (#1-2) on the finished wall. Remove the mounting plate (#1-2) from the bottom connection assembly.

Installation Option #1 - Drilling (solid wall)
 5.1. For a solid wall, use the supplied plastic anchors. Drill four 1/4" (6mm) holes into the finished wall. Insert the supplied plastic anchors (#1-1) into the drilled holes. Securely attach the mounting bracket (#1-2) onto the finished wall with the supplied screws (#1-3). Tighten with a Phillips screwdriver.

Installation Option #2 - Drilling (hollow wall)
 5.2. For a hollow wall, use the supplied spring toggle bolts. Drill either two 1/2" (12mm) holes in the horizontal or vertical direction into the finished wall. Assemble spring toggle anchor (#1-4) and screw (#1-5) with the mounting bracket (#1-2). Insert the spring toggle anchor (#1-4) through holes and tighten screws (#1-5) with a Phillips screwdriver.

NOTE: Only use two spring toggle anchors in opposite directions to avoid interference with each other behind the wall.

Installation Option #3 No Drill (gluing)
 5.3. Make sure that the mounting surface is made of solid and stable materials such as stone, ceramic tiles, glass, concrete or metal. Use a clean, soft cloth dampened with water or pure alcohol to remove any dirt and dust on the mounting surface. After the surface is dry, squeeze glue over the entire back surface of the brass mounting plate (#1-2). Use the supplied tool to smooth the glue. Firmly push the brass mounting plate (#1-2) onto the mounting surface at the pre-marked location. Clean away any excessive glue. Leave the glue to dry for 24 hours before completing installation.

6. Ensure that both round escutcheons (#2A and #5A) are attached on the main pipe assembly (#4) at the top and bottom connections. If not, remove set screws (#9 and #10) by using the supplied 3/32" (2.5mm) Allen wrench and then slide round escutcheons over the top and bottom connections. NOTE: The escutcheons provided are 50mm in diameter. If the hole cut in finished wall is larger than 50mm optional 65mm escutcheons are available for purchase.

7. Fit the main pipe assembly (#4) over the brass connector (#6) at the top and the mounting plate (#1-2) at the bottom connection.



8. Tighten set screw (#9 and #10) with the supplied 3/32" (2.5mm) Allen wrench to secure the main pipe assembly (#4).



9. Refer to Fig.1 and ensure that the hole located on the bottom of shower arm (#8A or #8B or #8C, depending on model chosen) is aligned with the hole on the plastic ring on the top brass connector. Push shower arm (#8A or #8B or #8C) onto the top brass connector of the main pipe assembly (#4). When inserted fully it should lock in place.

10. Tighten set screw (#7) with the supplied 3/32" (2.5mm) Allen wrench until the fixed shower arm is firmly in place. A swivel shower arm can be achieved by backing off set screw by half to one turn.

11. Screw elbow (#11) onto the bottom outlet of main pipe assembly (#4). Rotate the elbow (#11) to the desired direction and tighten nut with an adjustable wrench to fix the elbow.

Tools Required for Installations

-  3/32"(2.5mm) Allen Wrench (supplied)
-  Adjustable Wrench (not supplied)

-  Flat Head Screwdriver (not supplied)
-  Teflon Tape (not supplied)

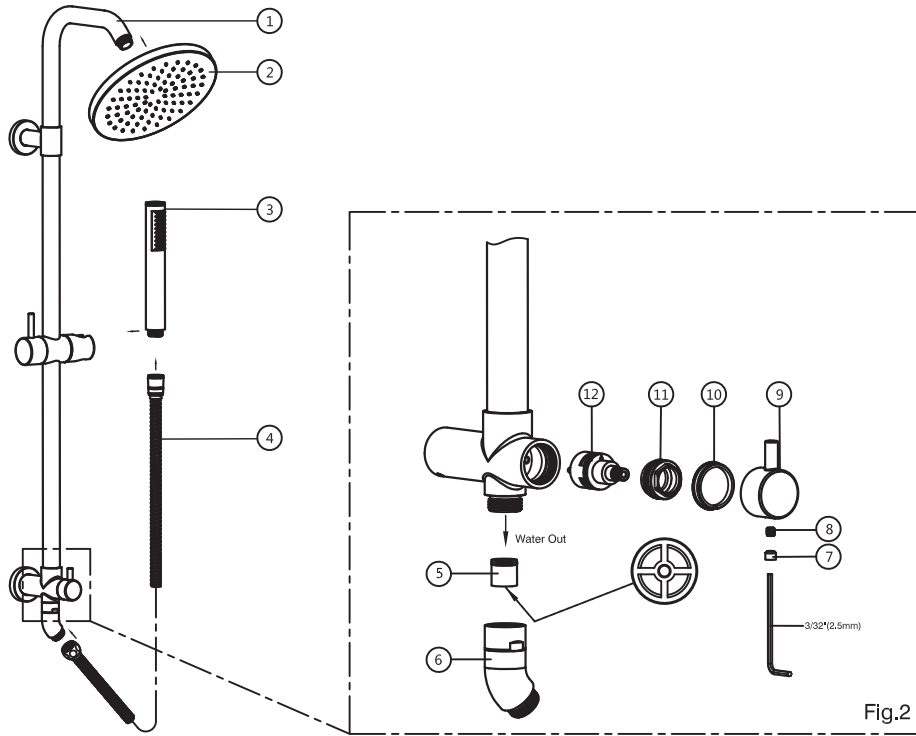

Operation Instructions

This switch retrofit shower system is tested and certified in compliance with the ASME plumbing code. This switch retrofit shower system is NOT tested and certified to the ANSI code for Grab Bars. It should NOT be used as a Grab Bar.

Switch retro-fit shower system is fitted with a two way diverter cartridge. When the diverter lever handle is pointed upwards, the mixed water travels upward to the fixed shower head. When the diverter lever handle is pointed downwards, the mixed water travels downward to the handheld shower wand.

The handheld shower holder can be moved up or down the slide rail by simply turning the handle to unlock, moving to the desired position and then locking back in place by returning the handle to the original position.

Installation Instructions

Fixed Showerhead and Handheld Shower Wand are NOT included in this package and must be purchased separately.

1. Apply Teflon tape onto the male threads at the end of shower arm (#1).
2. Thread shower head (#2) onto shower arm (#1) and tighten with an adjustable wrench.
3. Apply Teflon tape onto the male threads at the end of water outlet elbow (#6) as shown in Fig.2.
4. Ensure rubber seal washer is located inside the thread fittings of flex shower hose (#4).
5. Thread flex shower hose (#4) onto water outlet elbow (#6) and handheld shower wand (#3).

Care & Maintenance

fluid™ products are designed and engineered under strict quality standards. Regular and proper care of our products will ensure years of trouble-free service.

For Diverter Cartridge as shown in Fig.2:

1. Turn off water supplies.
2. Remove handle (#9) by untightening set screw (#8) using the supplied 3/32" (2.5mm) Allen wrench
3. Remove the decorative ring (#10) and then use an adjustable wrench to remove the retaining nut (#11). Pull the diverter cartridge (#12) out by hand.
4. Rinse with clean running water and then, if needed, soak in 50-50 vinegar/ water solution to remove calcium and mineral build-up.
5. To install diverter cartridge (#12), insert cartridge into valve cavity by aligning position pins on the bottom of cartridge with position holes in the valve cavity. Then push the cartridge (#12) into the valve cavity.
6. The diverter cartridge (#12) is properly installed if it cannot be turned to left or right by hand.

For Anti Backflow Device as shown in Fig.2:

1. Regularly remove the anti backflow device (#5) with small pliers from water outlet elbow (#6).
2. Rinse with clean running water and then if needed soak in 50-50 vinegar/ water solution to remove calcium and mineral build-up.
3. Re-install the anti backflow device (#5). Ensure the "Crossing" end faces outward. If inserted backwards, water will not flow through the water outlet elbow (#6).

For Surface Finish:

Clean with a damp cloth and warm soapy water. Then, simply rinse off and wipe dry with a soft cloth. Do not use abrasive or harsh cleaners as they may result in finish damage.